

Type FT with GS Elastic Coupling

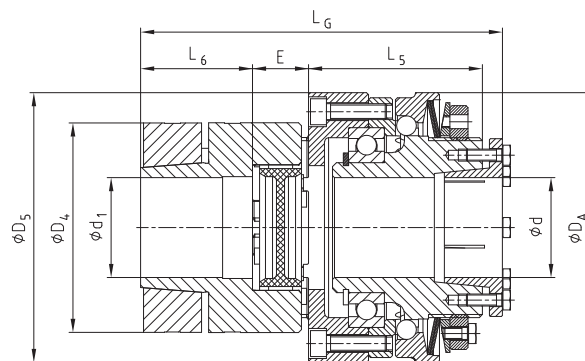

- Torque up to 3100 Nm
- Maximum shaft diameter up to 80 mm
- Backlash-free and vibration-reducing in combination with GS Coupling
- Drive and driven-sided with backlash-free, frictionally engaged shaft-hub-connection
- Synchronous and ratchet design
- Also available in combination with the torsionally stiff coupling
- Finish bore according to ISO fit H7, feather keyway according



Talent Compact with GS Coupling  
as shaft-to-shaft connection

Technical data															
Size	Speed [rpm]	Torques [Nm]				GS size	Max. finish bore		Dimensions [mm]						
		T1	T2	T3	T4		d	d1	D4	D5	L <sub>G</sub>	L <sub>5</sub>	L <sub>6</sub>	D <sub>A</sub>	E
01	4000	5-12.5	10-25	20-50	25-62.5	24	20	28	55	70	102	47	30	70	18
02	3000	10-25	20-50	40-100	50-125	28	25	38	65	85	119,5	56,5	35	85	20
03	2500	20-50	40-100	80-200	100-250	38	35	45	80	100	146	69	45	100	24
04	2000	40-100	80-200	160-400	200-500	42	45	55	95	115	159	74	50	115	26
05	1200	70-175	140-350	280-700	380-875	48	55	62	105	135	182	87	56	135	28
06	400	120-300	240-600	480-1200	600-1500	65	65	80	135	175	255	130	75	166	35

☒ Optionally available with clamping hub and keyway hub on request

Ordering example:	Talent Compact 1	DK	T2	4.5 / Ø25	GS 38	6.0 / Ø25	150 Nm
	Type/size	Type [DK/SK]	Disk spring	Hub design/bore	Type/size of coupling	GS hub	