

With a torsionally stiff Bellows Coupling

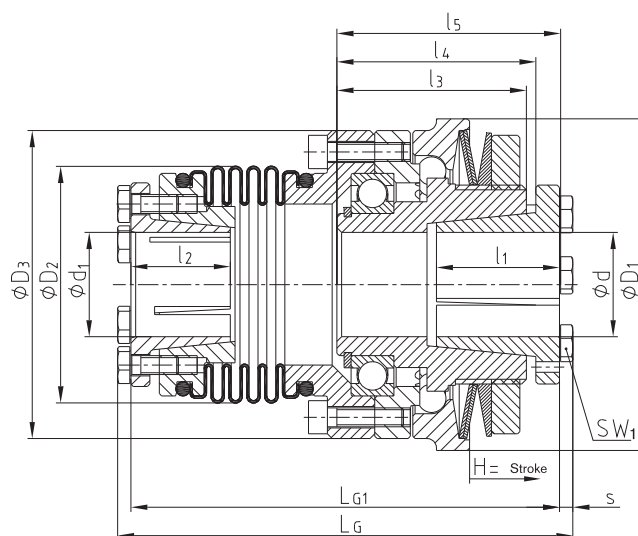

- Max. shaft diameter up to 56 mm
- Non-positive bellow-hub connection
- Maintenance-free
- Good properties of concentric running with high speeds



Talent Compact with Bellows Coupling

Technical data										
Talent Compact size	Bellows Coupling size	Bellows Coupling Max. speed [rpm]	torque [Nm]	Talent Compact torque [Nm]		Dimensions [mm]				
				T1	T2	max. d	max d ₁	D ₁	LG ²⁾	LG ₁ ²⁾
01	30	4000	30	5-12.5	10-25	20	22	70	-	96
02	38	3000	60	10-25	20-50	25	28	85	-	109
03	45	2500	150	20-50	40-100	35	38	100	-	135
04	55	2000	300	40-100	80-200	45	50	115	-	150

Dimensions											
Talent Compact size	size	Dimensions [mm]									
		D ₂	D ₃	l ₁	l ₂	l ₃	l ₄	l ₅	s	SW ₁	H
01	30	55,0	65	31	22	38	40,0	45	2,8	7	1,2
02	38	65,0	85	34	26	45	48,0	53	2,8	7	1,5
03	45	82,0	105	40	34	56	59,0	64	2,8	7	1,8
04	55	100,0	130	42	40	61	66,5	70	3,5	8	2,0

Optionally available with clamping hub on request.

Ordering example:	Talent Compact	03	45	DK	T2	d Ø40	d ₁ Ø40	100 Nm
	Type	Talent Compact size	Bellows Coupling size	Type [DK/SK]	Disk springs	Bore Talent Compact	Bore Bellows Coupling	Torque set